

LARGE JERSEY SHAPE BARRICADE

MB42X72JSS

The MB42x72 JSS barricade provides robust dependability for nearly every application. Leveraging the strengths of rotational molding, this barricade provides exceptional durability, even in extremely cold temperatures. It has been successfully deployed in northern Alaska and parts of Canada and can withstand severe weather conditions. It is ideal for use in low-speed construction zones, temporary or semi-permanent security applications, military bases, and for hazard identification. This barricade is the true workhorse of our product line.

All of our barricades are easy to deploy and adjacent units nest seamlessly to form a continuous wall and maneuver around obstacles. They are designed to be filled with water, but sand can also be used when more weight is needed. These parts have been used all over the world, in every possible scenario and have consistently exceeded expectations.

FEATURES & BENEFITS

- Exceptional environmental durability
- Multi-purpose
- Manufactured in OSHA approved orange and white
- Can be ballasted with water or sand

OPTIONAL CUSTOMIZATION

- Built-in post receptors can accommodate OTW Safety steel fence panel
- Spin welds accommodate additional hazard lights

COLORS

Safety orange and white (custom colors available).

COMPOSITION

Rotationally molded Linear Low Density Polyethylene (LLDPE).

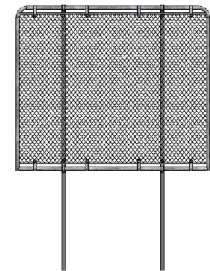
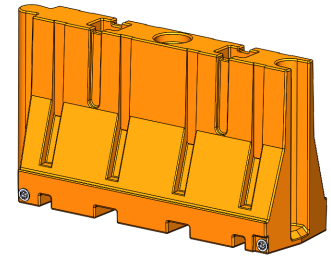

SIZE

Height: 42 in / 107 cm

Length: 72 in / 183 cm

Width: 24 in / 61 cm

WEIGHT

Empty: 78 lb / 35 kg

Ballasted: 953 lb / 432 kg

* Max recommended fill is 20 in.
or 105 gallons of water (weight calculation based on standard US gallons of water)

OPTIONAL FENCE PANEL

Post Height: 50 in / 127 cm

Fence Height: 60 in / 152 cm

Total Height: 110 in (9 ft 2 in) / 279 cm

Width: 70.75 in (5 ft 10 3/4 in) / 180 cm